

# K105F

## Intel ALDER LAKE Platform Mini PC

JWIPC K105F is a cost-efficient, versatile Intel-based fanless Mini PC designed for office operation and industrial application, an ideal Digital Signage, KIOSK and Bank Information Release solution.



- Based on Intel Alder Lake Platform with fanless design
- Support dual channel DDR4 memory
- Support 1 x M.2 Key M 2242/2280 SATA/NVMe interface
- Support 1 x 2.5" SATA Interface
- Support 2 x HDMI Display port, 1 x DP display port
- Support WIFI6、 4G/5G extension
- Support 2 x 1000M Ethernet RJ45 port
- Support 2 x USB3.1, 4 x USB2.0
- Support 2 x RS232 COM port
- Support TPM2.0 security encryption module
- Support Windows11/Linux OS

## Specifications

<b>Processor System</b>	CPU	Intel® Alder Lake Processor Max. TDP=15w
	Chipset	SOC
	BIOS	AMI UEFI BIOS
<b>Graphics</b>	Graphic card	Intel® Iris® Xe Graphics
	Multi displays	Support Three displays
	Interface	2 x HDMI2.0 4K60Hz, 1 x DP1.4 8K30Hz output
<b>Memory</b>	Type	Dual Channel So DIMM DDR4, Max. 3200MHz
	Max	32 GB
<b>Ethernet</b>	Lan IC	2 x RTL8111H
	Interface	10/100/1000Mbps
	Connector	2 x RJ45
<b>Wireless</b>	Type	Wi-Fi/BT module
	Interface	1 x M.2 Key E 2230 slot
<b>4G/5G</b>	Type	4G/5G Mobile network
	Interface	1 x M.2 slot for 3042/3052 size 4G/5G module card
<b>Storage</b>	Type	SATA/NVMe SSD
	Interface	1 x M.2 Key M slot for 2242/2280 size SSD
	Type	SATA
<b>IO Interface</b>	Interface	1 x 2.5" SATA Interface
	Front panel	1 x PowerButton 2 x USB3.1, 1 x Type-C (USB3.1) 1 x MIC IN, 1 x Line out
	Rear panel	2 x RJ45, 4 x USB2.0, 2 x HDMI, 1 x DP1.4, 1 x 2.5/5.5 DC-IN Connector
<b>Software</b>	OS Supports	Windows11/Linux
	Watchdog	Support
	vPro/AMT	No support
	TPM	Physical TPM2.0 chip
<b>Power</b>	Power input	12-19v 2.5/5.5 DC-In
<b>Size</b>	Dimension	190(L) x 148(W) x 45(H) mm
<b>Environment</b>	Operating Temp.	-5~45°C
	Operating Humidity	10%~90% non-condensing
	Storage Temp.	-20~70°C
	Operating Humidity	5%~95% non-condensing

## Product view

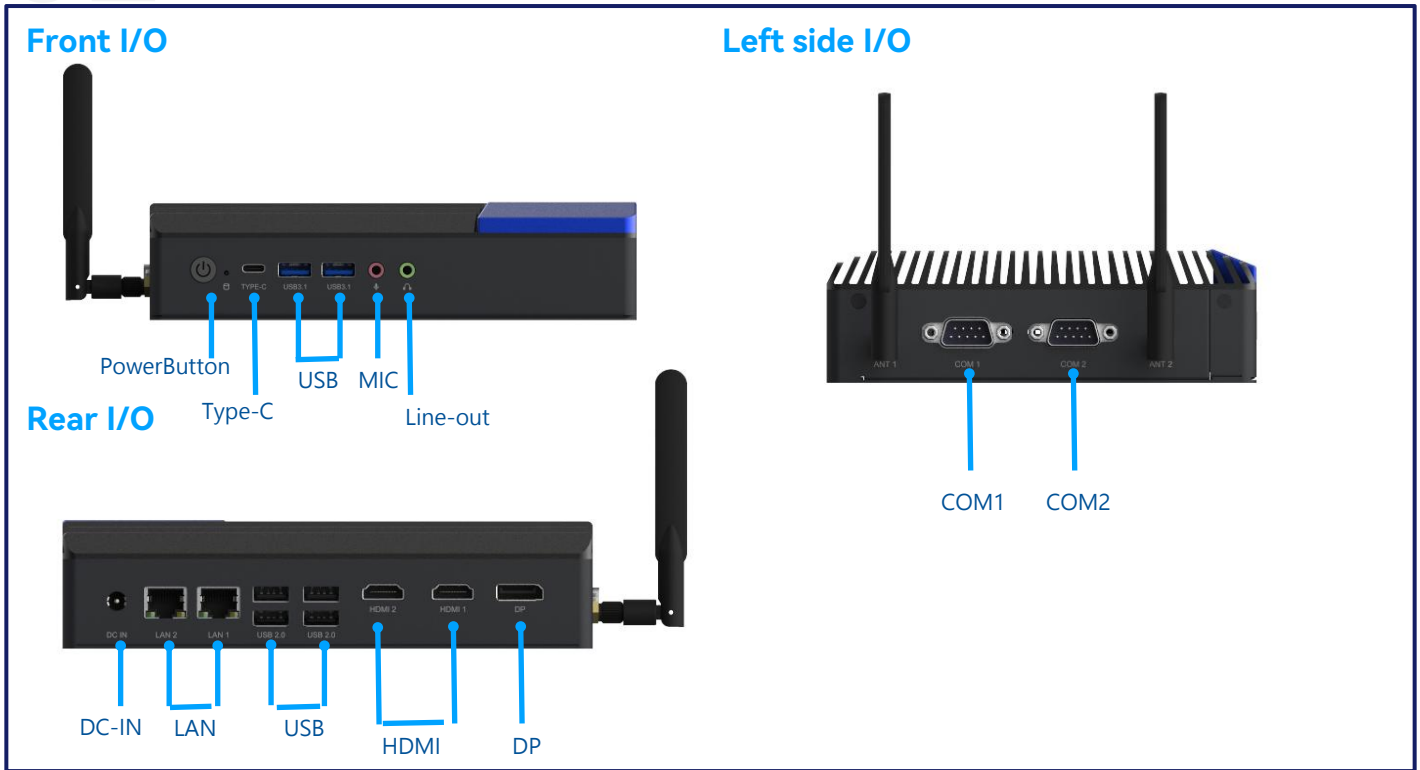

## Dimensions

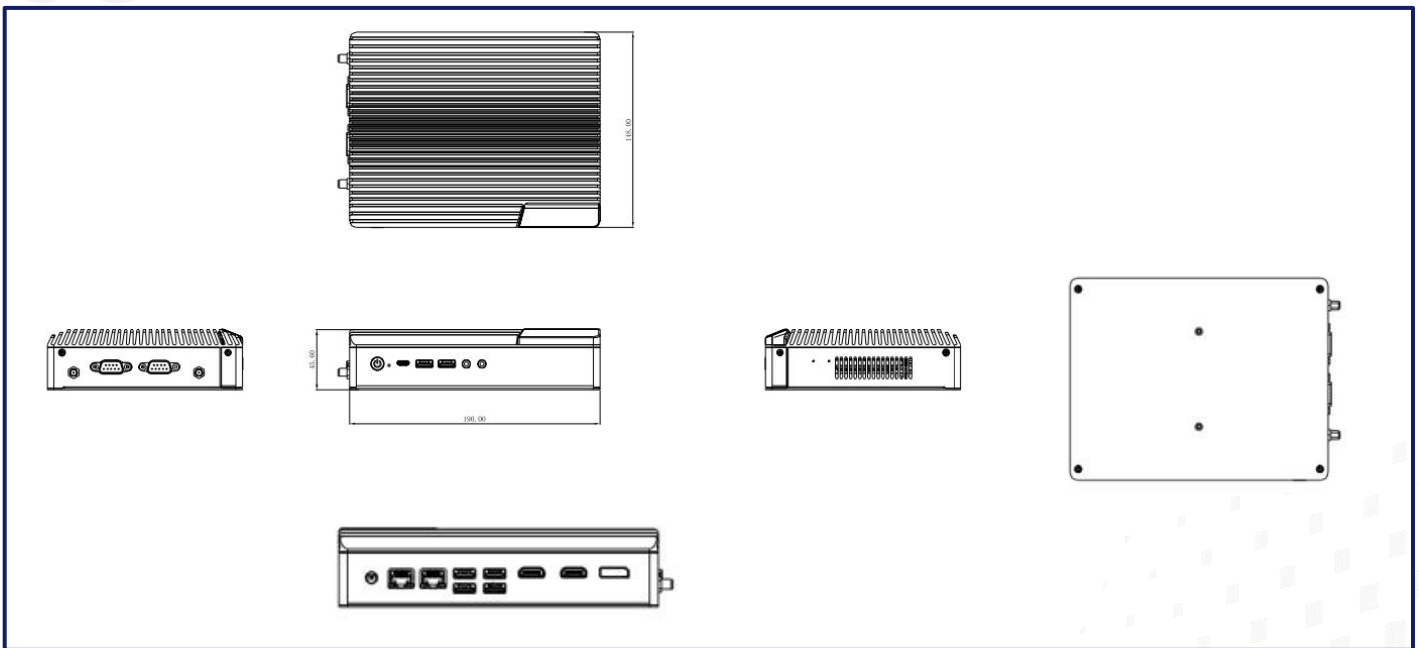

## Ordering Information

Model	Description
K105F-Celeron	Intel Celeron 7305/2* DDR4/2* RJ45/2* HDMI+1* DP/1* M.2 KeyM SSD/1* 2.5'' SATA Interface /4* USB2.0+2*USB3.1+ 1* Type-C
K105F-I3	Intel I3-1215U/2* DDR4/2* RJ45/2* HDMI+1* DP/1* M.2 KeyM SSD/1* 2.5'' SATA Interface /4* USB2.0+2*USB3.1+ 1* Type-C
K105F-I5	Intel I5-1235U/2* DDR4/2* RJ45/2* HDMI+1* DP/1* M.2 KeyM SSD/1* 2.5'' SATA Interface /4* USB2.0+2*USB3.1+ 1* Type-C
K105F-I7	Intel I7-1255U/2* DDR4/2* RJ45/2* HDMI+1* DP/1* M.2 KeyM SSD/1* 2.5'' SATA Interface /4* USB2.0+2*USB3.1+ 1* Type-C